

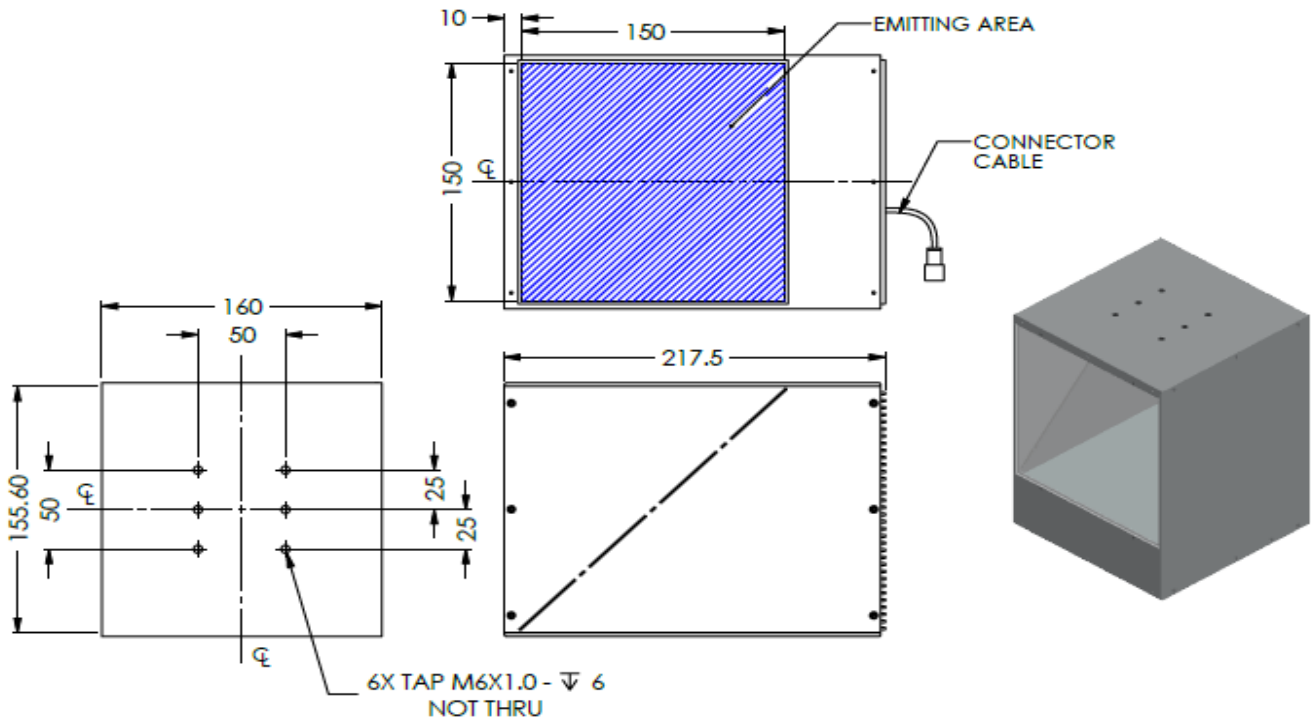

# ILLUMINATOR DATA - ID

## CAS3-00-150-X-B-24V

### Lighting Dimension



Mechanical Information	
Casing Material	Aluminium
Storage Temperature Range	Temp 0-45°C, Humidity 20-85%
Weight	2000g
Length / Outer Diameter	217.5 mm
Width / Inner Diameter	160 mm
Thickness	155.6 mm



# ILLUMINATOR DATA - ID

## CAS3-00-150-X-B-24V

Optical Information				
Part Number		CAS3-00-150-X-B-24V		
LED Color		BLUE		
Wavelength	(nm)	450		
Intensity (±15%)	(Lux)	1085.4	976.05	869.4
Working Distance	(mm)	100	110	120
Illumination (number of row)		X		
Illumination Active Area				
Active Length / Outer Dia.	(mm)	150		
Active Width / Inner Dia.		150		
Emission angle	(deg.)	0		
Eye Safety Class ( IEC62471 )		II		
Electrical Information				
Lighting Supply Voltage (constant voltage mode)		24V ± 2%		
Continuous Current	(mA)	891		
Power Consumption	(W)	21.38		
Lighting casing temperature, Operating after 60 minutes	°C	53.9		
Strobe Mode Specification				
Pulse Operation		YES		
Max. Lighting Supply Voltage (Constant voltage power supply)	(V)	Pulsing at 24VDC to 48VDC, 0-10% Duty Cycle Recommended at 36VDC		
Pulse Current, (Max. 10msec) (Constant current power supply)	(mA)	8100		
Max. Trigger Pulse Duration	(msec)	10		
Duty Cycle		0-10%		
Additional Information				
Additional Cooling Method		Attached to machine part for better heat dissipation		
Intensity Controller Selection		ANGX, ST and SD series		
CE Conformity		YES		
RoHS Compliance		YES		
Connection				
Connector Type (Default):		JST SMR-03V		
Cable Length out from lighting :	(mm)	500		
Pin Configuration :		Pin	Signal	Cable Color
		1	LED +	RED
		2	N.C.	---
		3	LED -	WHITE
				
Application				
Illumination Type		Coaxial Illumination		
Application Use		Surface inspection and alignment, water, metal surface film, LCD and glass, pattern on PCB		