

ELSB Series Instruction Guide



Thank you for purchasing a CCS product. To ensure proper use of the product, please read this instruction guide before use and keep it for your reference.

1 Important Information for Equipment Safety

This product has been designed with full consideration of safety. However, incorrect usage of the product may result in fire, electric shock, or other serious damages. Please ensure to follow the conditions below.

Warning

Do not look directly or with any optical instrument into the light beam	Make sure you are using a correct power supply before connecting the device
Avoid any contact with the LED or with the projection lens	Do not inverse the electrical polarity. Check your connections before turning on the power supply
IP67: Total dust protection, do not immerse the product deeper than 1 meter into water	Do not use user-made cables, only dedicated EL Series cables
Do not use the device in an environment with oil fumes and steam	Do not touch the light unit and cables with wet hands
Make sure that the light unit is free of moisture or any liquid. Exposure to water may result in fire or electric shock	Do not drop the light unit or subject it to impact
Do not try to fix any damages to the product by yourself	

Do not use the light in the following situations:

- Under no conditions or in an environment not described in this instruction guide
- In applications involving serious risk to life or property, particularly application demanding a high level of safety.
- Do not use this device outside an environment temperature of 0°C to 50°C with no excessive moisture levels. High humidity and high temperature could damage the device. Just check with the temperature on the datasheet.

Always observe the following precautions when performing maintenance.

- Before performing maintenance, always turn off the power. Otherwise, burn injuries or electric shock may occur.
- Wipe the light unit with a dry cloth. Do not wipe the light unit with a cloth that contains water or volatile agents, such as thinner or benzene, or spray the light units with insecticide. Doing so may result in discoloration or damage.
- Periodically clean the light unit so that dust does not collect on it.

Cleaning

- When changing the optical configuration of the ELSB Series, please exercise caution. Wearing gloves is strongly recommended.
- When cleaning the optical components, use compressed air if there is any dust.
- To remove marks on the lens or diffuser plate, please use lens clearing fluids.
- Two drops on a cleaning tissue will suffice. Please use a gentle circular motion when clearing.
- Disconnect the light

2 Confirming Product Information

The following sticker is attached to the light unit. The sticker indicates the color of the light, model number, power consumption unit, and serial number. Be sure to check the contents before using the light units and handle the sticker with care. If the label is missing or damaged and the contents cannot be checked, please contact your CCS representative.

Example image

ELSB-55RD
Serial: 0126331902-001
CE
www.el-series.com
24V DC-5W
TRIG - 24V

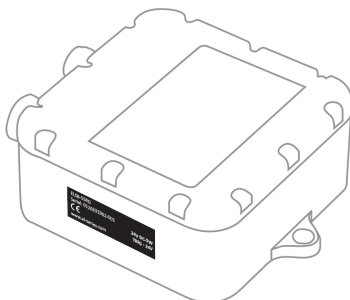

3 Optical flexibility

All standard ELSB Series products come with three different diffusers and the lenses on position P2.

To change the diffuser or the lens position, you must open the light unit. Top open the light unit, unscrew the screws on the top light unit. After removing the top parts:

- Gently take out the diffuser and replace it with one of the other supplied diffuser.
- Unscrew the lens block, and take out the two spacers. Replace the lens block in the preferred position by using the spacers. Screw back the lens block and cover (0.2N.m).

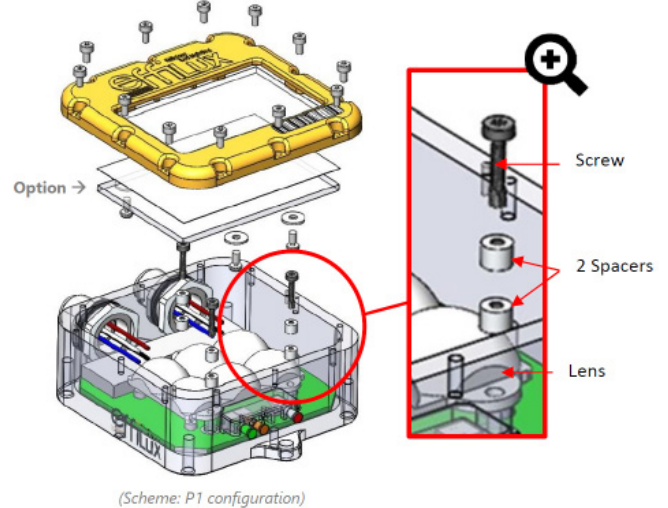

Please note that opening the product might compromise the IP-rating, if not closed properly afterwards.

4 Main Specifications

Power consumption is given for white products. Power consumption for other wavelengths may differ. The power consumption will be specified on the products.

ELSB-55

Series	Part Number	Color	Wavelength / Color temperature	Max Power Consumption	Connector	Weight
ELSB	ELSB-55SW	White	5500 K ± 500 K	15 W	2X M12-5 (M&F)	180 g
ELSB	ELSB-55UV	Ultraviolet	405 nm			
ELSB	ELSB-55BL	Blue	465 nm			
ELSB	ELSB-55GR	Green	525 nm			
ELSB	ELSB-55RD	Red	625 nm			
ELSB	ELSB-55IR	Infrared	850 nm			

ELSB-105

Series	Part Number	Color	Wavelength / Color temperature	Max Power Consumption	Connector	Weight
ELSB	ELSB-105SW	White	5500 K ± 500 K	30 W	2X M12-5 (M&F)	180 g
ELSB	ELSB-105UV	Ultraviolet	405 nm			
ELSB	ELSB-105BL	Blue	465 nm			
ELSB	ELSB-105GR	Green	525 nm			
ELSB	ELSB-105RD	Red	625 nm			
ELSB	ELSB-105IR	Infrared	850 nm			

ELSB-285

Series	Part Number	Color	Wavelength / Color temperature	Max Power Consumption	Connector	Weight
ELSB	ELSB-285SW	White	5500 K ± 500 K	15 W	2X M12-5 (M&F)	180 g
ELSB	ELSB-285UV	Ultraviolet	405 nm			
ELSB	ELSB-285BL	Blue	465 nm			
ELSB	ELSB-285GR	Green	525 nm			
ELSB	ELSB-285RD	Red	625 nm			
ELSB	ELSB-285IR	Infrared	850 nm			

ELSB-55

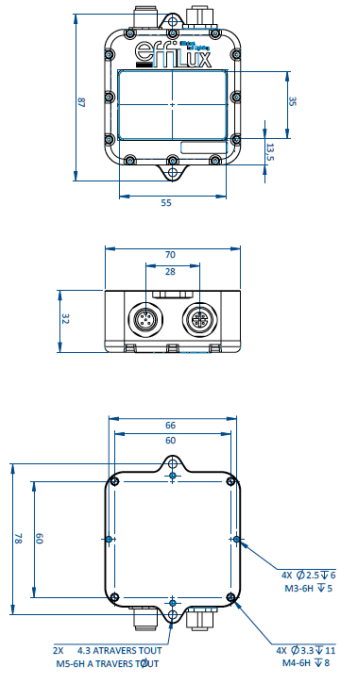

ELSB-105

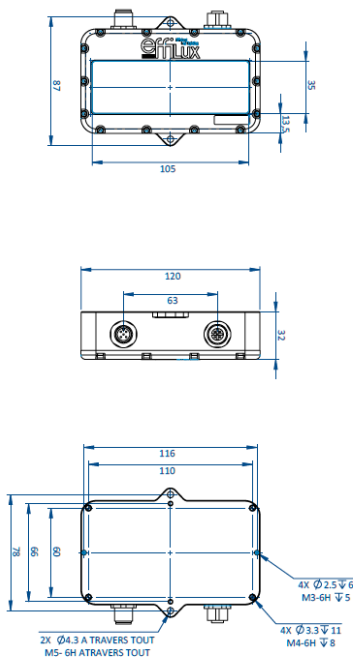

ELSB-285

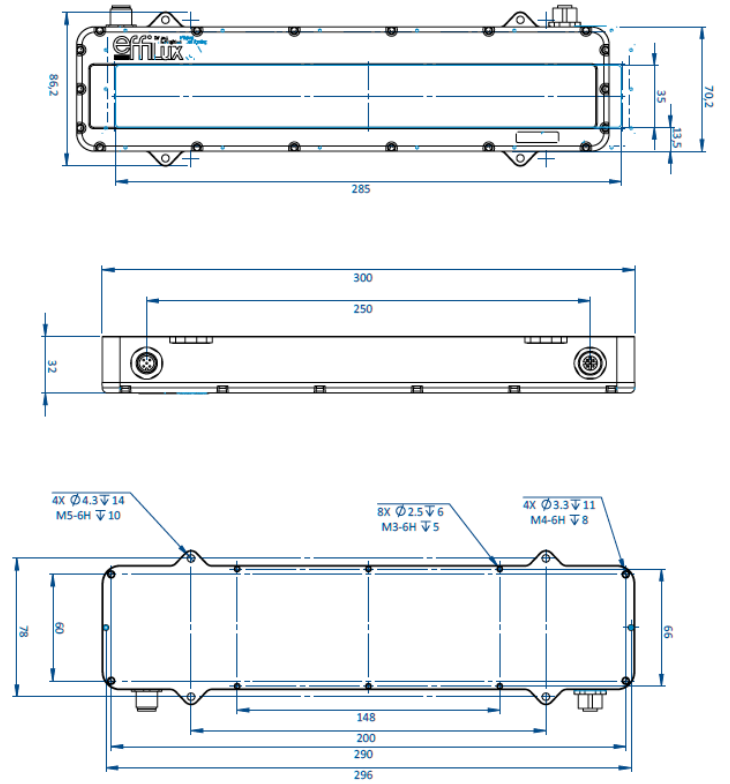

When using the ELSB Series, please use a 24V DC. Please note that trigger needs to be connected when using the ELSB Series.

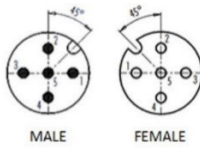
Contact arrangement	Number	Color contact	Designation
 <p>M12 male & female connectors</p>	1	Brown	+24V
	2	White	NPN TRIGGER (trigger on falling edge) for Auto-strobe Light ON if $V_{NPN} < 1.5V$ DC max consumption = 0.1 mA - max 24V - Analog Voltage
	3	Blue	GND
	4	Black	PNP TRIGGER [trigger for rising edge] for Auto-strobe Light ON if $V_{PNP} > 3V$ DC max consumption = 2mA - max 24V - Analog Voltage
	5	Grey	AIC: Analog Intensity Control for Dimming Control Consumption = 1mA @ 10V & 2mA @ 24V Suggested dimming range: min 5V - max 24V

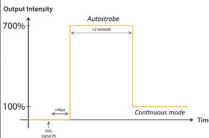
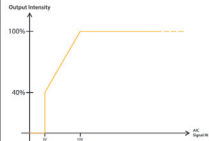
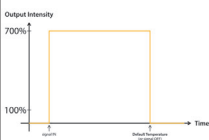
ELECTRONICAL MODES						
Mode	Designation	Contact arrangement				
		pin1	pin2	pin3	pin4	pin5
AUTOSTROBE 	PNP: Strobe control triggered on rising edge . N.B: For the strobe mode please respect a duty cycle (DC) lower than 0.25.	+24V	not connected (≠ 0V)	GND	> 3Vdc max 24Vdc	not connected (≠ 0V)
	NPN: Strobe control triggered on falling edge . N.B: For the strobe mode please respect a duty cycle (DC) lower than 0.25.	+24V	< 1.5Vdc	GND	not connected (≠ 0V)	not connected (≠ 0V)
DIMMING CONTROL 	Analog intensity control LED OFF: 0-3V LED ON: 3V (40%) - 10V (100%) LED ON: 10-24V (100%)	+24V	not connected (≠ 0V)	GND	not connected (≠ 0V)	AIC: 0-24V See scheme
TEST MODE 	LED are supplied with I_{max} (700%) until default temperature is activated. Do not use with external trigger, just for continuous. Signal consumption : 4mA Do not touch the product (WARM)	+24V	> 3Vdc max 24Vdc (or not connected)	GND	> 3Vdc max 24Vdc	> 3Vdc max 24Vdc

Warranty Information

EXCEPT FOR THE EXPRESS WARRANTIES STATED IN THIS DOCUMENT, CCS MAKES NO ADDITIONAL WARRANTIES, EXPRESS, IMPLIED, OR STATUTORY, AS TO ANY MATTER WHATSOEVER. IN PARTICULAR, ANY AND ALL WARRANTIES OF MERCHANTABILITY OR FITNESS FOR PARTICULAR PURPOSE ARE EXPRESSLY EXCLUDED. EXCEPT AS EXPRESSLY SET FORTH HEREIN, CCS MAKES NO WARRANTIES WITH RESPECT TO THE PRODUCTS.

WARRANTY PERIOD: EL SERIES PRODUCTS HAVE A WARRANTY OF 2 YEARS (ONE YEAR FOR RADIANT QUANTITY) FROM THE DATE THE PRODUCT IS SHIPPED FROM THE MANUFACTURER. EXCEPTIONS ARE UV PRODUCTS (WAVELENGTH UNDER 420NM) WHICH HAVE A WARRANTY OF 1 YEAR, AND POLARIZERS WHICH HAVE NO WARRANTY.

CCS Inc. WILL REPAIR OR REPLACE THE PRODUCT FREE OF CHARGE IF IT SHOULD FAIL TO FUNCTION OR IF THE RADIANT QUANTITY OF THE PRODUCT SHOULD DROP TO 50% OR LESS OF ITS INITIAL RADIANT QUANTITY WITHIN THE SPECIFIED WARRANTY PERIOD. IF EITHER OF THESE CONDITIONS OCCURS, PLEASE TAKE THE PRODUCT TO YOUR CCS SALES REPRESENTATIVE.

WARRANTY TERMS

- CCS Inc. WILL REPAIR OR REPLACE THE PRODUCT FREE OF CHARGE IF IT SHOULD FAIL TO FUNCTION UNDER USE ON OUR SPECIFIED CONDITION IN ACCORDANCE WITH THE INSTRUCTION GUIDE AND OTHER WRITTEN CAUTIONS DURING THE INDICATED WARRANTY PERIOD OF TWO YEARS.
- CCS Inc. WILL REPAIR OR REPLACE THE PRODUCT FREE OF CHARGE IF ITS RADIANT QUANTITY SHOULD DROP TO 50% OR LESS OF ITS INITIAL RADIANT QUANTITY UNDER USE ON OUR SPECIFIED CONDITION IN ACCORDANCE WITH THE INSTRUCTION GUIDE AND OTHER WRITTEN CAUTIONS DURING THE INDICATED WARRANTY PERIOD OF ONE YEAR.
- CCS Inc. WILL CHARGE A REPAIR FEE UNDER THE FOLLOWING CONDITIONS:
 - IF THE PRODUCT HAS BEEN SUBJECTED TO MISUSE, UNAUTHORIZED REPAIRS, OR MODIFICATION FROM ITS ORIGINAL DESIGN.
 - IF THE PRODUCT HAS BEEN DAMAGED FROM IMPACTS DUE TO INAPPROPRIATE HANDLING.
 - IF DAMAGE TO THE PRODUCT RESULTS FROM EXTERNAL CAUSES INCLUDING ACCIDENTS, FIRE, POLLUTION, RIOTS, COMMUNICATION FAILURES, EARTHQUAKES, THUNDERSTORMS, WIND AND FLOOD DAMAGE, OR ANY OTHER ACT OF PROVIDENCE, OR FROM ANY EXTRAORDINARY CONDITIONS SUCH AS ELECTRICAL SURGES, WATER LEAKAGE, CONDENSATION, OR THE USE OF CHEMICALS.
 - IF THE DAMAGE RESULTS FROM CONNECTION TO ANY POWER SUPPLY OR TO ANY EQUIPMENT WHICH CCS Inc. DOES NOT MANUFACTURE OR DOES NOT SPECIFY FOR USE.
- CCS ASSUMES NO LIABILITY FOR ANY PURCHASER'S SECONDARY DAMAGE (DAMAGE OF EQUIPMENT, LOSS OF OPPORTUNITIES, LOSS OF PROFITS, ETC.) OR ANY OTHER DAMAGE RESULTING FROM A FAILURE OF OUR PRODUCT.

THIS WARRANTY INFORMATION PROVIDES THE SCOPE OF CCS'S PRODUCT WARRANTY WITHIN THE SPECIFIED PERIOD, AND DOES NOT INDICATE OR IMPLY ANY FURTHER GUARANTEE BEYOND THE WARRANTY TERMS.

CONTACT CCS FOR INQUIRIES OR INFORMATION ON REPAIRS TO THE PRODUCT AFTER THE EXPIRATION OF THE WARRANTY.

NOTE: THE RADIANT QUANTITY REFERS TO THE WATTAGE OF PHYSICAL ENERGY RADIATED FROM AN LED. IT REFERS TO THE RADIATION LUMINOSITY OF THE LED MEASURED UNDER CONDITIONS SPECIFIED BY CCS OR THE RADIATION ILLUMINATION OF THE LED UNDER SPECIFIED IRRADIATION CONDITIONS. CCS SPECIFIES THE RADIANT QUANTITY FOR EACH LED LIGHT BECAUSE THE MEASUREMENT AND IRRADIATION CONDITIONS VARY FROM THE FORM, THE APPLICATION AND THE IRRADIATION WAVELENGTH.

- Contents of this Instruction Guide may be changed without prior notice.
- Illustrations used in this Instruction Guide may differ from actual products.
- CCS maintains the copyright on this Instruction Guide. Unauthorized transfer or reproduction is strictly prohibited.

Instruction Guide and Dimensional Diagrams in PDF or CAD can be downloaded from the CCS website.
<http://www.el-series.com>

Ask any product queries to the following address or to your nearest CCS representative.

CCS CCS Inc.

Headquarters Shimodachiur i-agaru, Karasuma-dori, Kamigyo-ku, Kyoto 602-8011 Japan
 Phone : +81-75-415-8284 Fax : +81-75-415-8278 E-mail : intlsales@ccs-inc.co.jp
 Use our website to find nearest CCS representative <http://www.ccs-grp.com/mvad>

Copyright© 2019 CCS Inc. All Rights Reserved.
 Descriptions in this instruction guide are based on information available as of March 2019.
 The EL Series is manufactured by Effilux in France.

7 Environmental Regulation

EU RoHS Directive

The RoHS Directive is short for the "Restriction of use of certain Hazardous Substances in electrical and electronic equipment." As a directive, it restricts the use of specific hazardous substances for new electrical and electronic equipment marketed in the EU on or after July 1, 2006, and restricts the use of six substances, which are (1) lead, (2) mercury, (3) cadmium, (4) hexavalent chromium, (5) polybrominated biphenyl (PBB), and (6) polybrominated diphenyl ether (PBDE).

*Standards for "RoHS Directive-Compliant Products"

Lead	Mercury	Cadmium	Hexavalent chromium	PBB	PBDE
1000ppm max.	1000ppm max.	1000ppm max.	1000ppm max.	1000ppm max.	1000ppm max.

(Items that are exempted in the RoHS Directive are excluded from these standards.)